



## 2 Rollers

series

**PL 2**

**PL 3**

**PL 4**

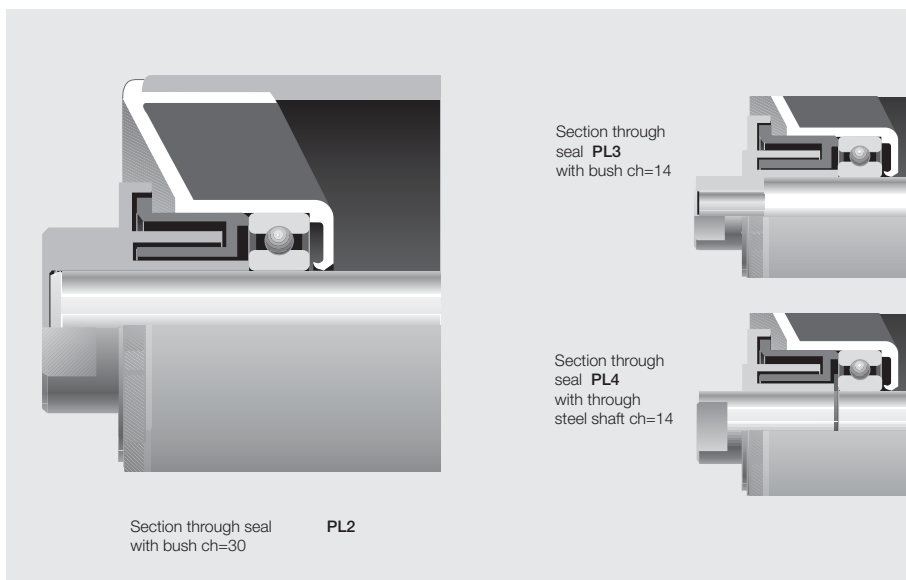

**Ø 90 V**

Bearing 6204  
(20 X 47 X 14)

**PL 2**

d = 20  
d<sub>1</sub> = 35  
ch = 30  
s = 4,3  
e = 4  
g = 10

**PL 4**

d = 20  
d<sub>1</sub> = 20  
ch = 14  
s = 4,3  
e = 4  
g = 10

**PL 3**

d = 20  
d<sub>1</sub> = 20  
ch = 14\*  
s = 4,3  
e = 4  
g = 10

\* on request ch=18

belt		roller										
width mm	arrangements	dimensions mm			weight Kg		load capacity daN					
		B	C	A	rotating parts	total	belt speed m/s					
							1	1.25	1.5	1.75	2	2.5
400		160	168	188	0.7	1.2	97	88	80	75	70	63
500		200	208	228	0.8	1.3	97	88	80	75	70	63
400	650	250	258	278	0.8	1.5	97	88	80	75	70	63
500	800	315	323	343	1.0	1.8	97	88	80	75	70	63
650	1000	380	388	408	1.1	2.1	97	88	80	75	70	63
800	1200	465	473	493	1.2	2.4	97	88	80	75	70	63
400		500	508	528	1.3	2.6	97	88	80	75	70	63
500	1000	600	608	628	1.5	3.0	97	88	80	75	70	63
	1200	700	708	728	1.6	3.4	97	88	80	75	70	63
650		750	758	778	1.7	3.6	97	88	80	75	70	63
800		950	958	978	2.1	4.5	50	50	50	50	50	50
1000		1150	1158	1178	2.4	5.3	28	28	28	28	28	28
1200		1400	1408	1428	2.8	6.3	16	16	16	16	16	16

The indicated load capacity relates to a project working life of 10,000 hours.

**Example of ordering**

standard design  
PL2,20N,90V,323  
PL3,20N,90V,388  
PL4,20F,90V,508

PL3,20N18,90V,538  
PL4,20F15,90V,608

for special design  
see pages 80-81